



Community Development
Department

FIREPLACES

Permit Procedure:

1. Submit a completed permit application.
2. If a contractor is used, s/he must be licensed by the Village.
3. Submit a copy of the plat of survey showing location of fireplace.
4. Submit a copy of the installation instructions, a drawing showing framing, fire stopping and hearth details.

Specifications:

1. Chimneys shall be structurally sound, durable, smoke-tight, and capable of conveying flue gases to the exterior safely. Masonry chimneys shall be supported on foundations, concrete at least twelve inches (12") thick and at least six inches (6") beyond each side of the exterior dimensions of the chimney. Footings shall be founded on natural undisturbed earth below the frostline (*IRC-R1001.2).
2. Corbeling: Masonry chimneys should not be corbeled more than one inch (1") from a wall or foundation, nor should a chimney be corbeled from a wall or foundation which is less than twelve inches (12") in thickness unless it projects equally on each side of the wall, except that on the second story of a two-story dwelling, corbeling of chimneys on the exterior of the enclosing walls may equal the wall thickness. Corbeling shall not exceed one inch (1") projection for each course (*IRC-R1003.5).
3. Changes in dimension: The chimney wall or chimney flue lining shall not change in size or shape within six inches (6") above or below where the chimney passes through floor components, ceiling components, or roof components (*IRC-R1003.6).
4. Additional load: Chimneys shall not support loads other than their own weight unless they are designed and constructed to support the additional load (*IRC-R1003.8).
5. Termination: Chimneys shall extend at least two feet (2') higher than any portion of the building within ten feet (10'), but shall not be less than three feet (3') above the point where the chimney passes through the roof (*IRC-R1003.9).
6. Wall thickness: Masonry chimney walls shall be constructed of solid masonry units with not less than four inches (4") nominal thickness (*IRC-R1003.10).
7. Flue lining (material): Masonry chimneys shall be lined with fireclay flue liners not less than 5/8" in thickness or with other approved liner of material that will resist, without

cracking or softening, a temperature of 1,800 degrees Fahrenheit (*IRC-R1003.11).

Exception: Masonry chimneys may be constructed without flue liners when walls are at least 8 inches (8") in thickness of solid masonry.

8. Cleanout opening: Cleanout openings, when provided, shall be equipped with ferrous metal doors and frames constructed to remain tightly closed, except when in use. Cleanouts shall be accessible and so located that ash removal will not create a hazard to combustible materials (*IRC-R1001.2.1).
9. Hearth extension: The hearth and the hearth extension shall extend a minimum of 36 inches (36") from the back of the firebox to the end of the hearth extension. Hearth extensions shall extend at least sixteen inches (16") in front of, and at least eight inches (8") beyond, each side of the fireplace opening. Where the fireplace opening is six square feet (6' sq.) or larger, the hearth extension shall extend at least twenty inches (20") in front of, and at least twelve inches (12") beyond, each side of the fireplace opening (*IRC-R1001.10).
10. Fireplace outlets: Gas outlets located in fireplaces shall be controlled by labeled valves located in the same room outside the firebox and not more than six feet (6') from the outlets (*IFGC-409.5.1).
11. Factory-Built Fireplaces: Installation - Factory-built fireplaces that consist of a fire chamber assembly, one or more chimney sections, a roof assembly and other parts as tested and listed as an assembly by an approved agency, may be installed. No loose insulation in fireplace chase allowed. Five-eighths inch (5/8") type X drywall is required on inside of chase to firestop. Metal strip eight inches (8") wide required between fireplace and hearth (*IRC-R1004.1).
12. Factory-Built Fireplace Stoves: Factory-built fireplace stoves consisting of a freestanding fire chamber assembly that have been tested and are listed by a nationally recognized testing laboratory, shall be installed in accordance with the requirements of said listing and the manufacturer's instructions. The supporting structure for a hearth extension shall be at the same level as the supporting structure for the fireplace unit. Factory-built fireplaces to be built similar to the following sketches (see attachment).
13. Exterior air: Factory-built or masonry fireplaces covered in this chapter shall be equipped with an exterior air supply to assure proper fuel combustion (*IRC-R1006.1).
14. New wood burning fireplaces shall have gasketed doors.

References (revised 01/2014):

*IRC = International Residential Code (2012)

*IFGC=International Fuel Gas Code (2012)

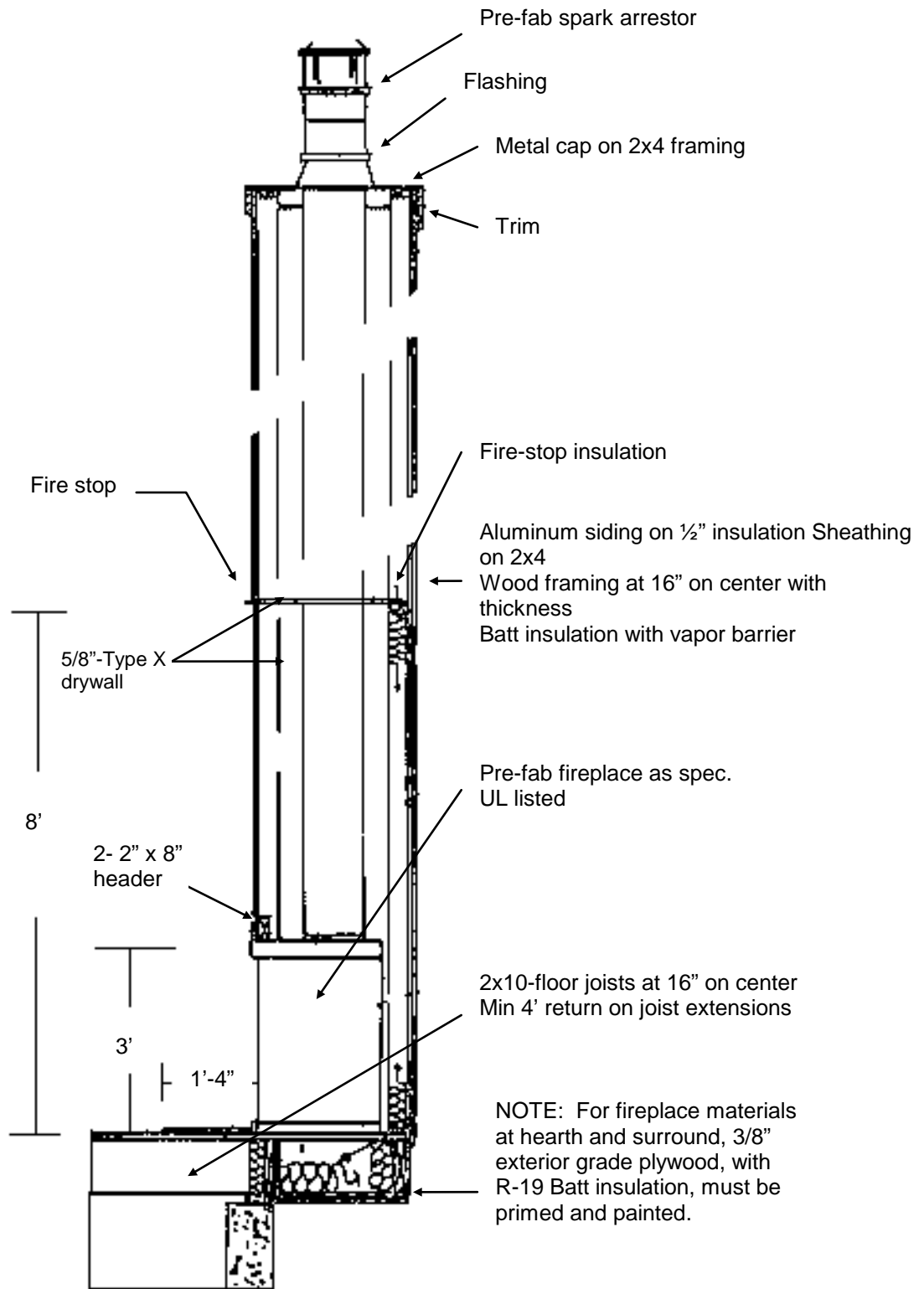

NOTE: Concrete wing wall or other approved support required on slab installations.